

# EDGE 160 ESU

INFINIUM®

## EDGE 160

## ELECTROSURGICAL GENERATOR

The EDGE160 is a high-frequency electrosurgical generator suitable for light and medium surgery. It features pure CUT, BLEND, FORCED COAG (superficial), SOFT COAG (deep), and optional BIPOLAR coagulation.

Digital power readings and continuous monitoring of operative functions guarantee reliable conditions within the surgical field.

The EDGE160 allows for professional surgeries thanks to built-in safety features. The connection of the neutral electrode as well as the patient plate is constantly monitored. The hand control of monopolar output functions and power allows surgeons to focus on the surgical field at all times.

- Plate and power monitoring & control
- Split return electrode use
- Minimally invasive surgical treatments
- Optional bipolar forceps configuration
- Auto start/stop in bipolar coag
- Saves last used setting
- Monopolar activation with handle and/or pedal
- Digital power regulation and output indicator
- Sound level controls

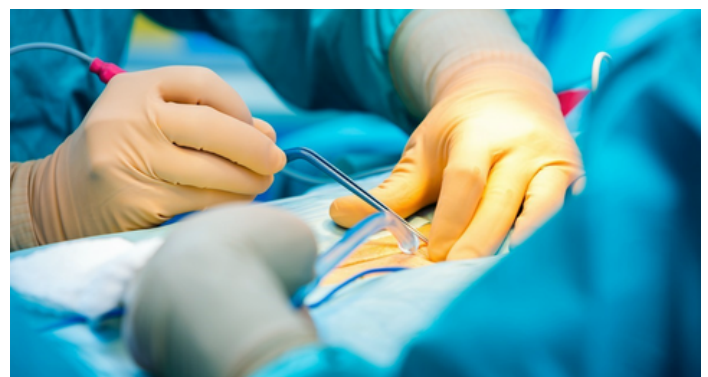

# EDGE 160 Technical Specifications

| Toll.    | Description   | EDGE 160         |
|----------|---|------------------|
|          | Electrosurgical unit code                             | EKM10100.201A    |
| ± 0%     | Minimum preselectable power                           | 0                |
|          | Level step  | 1                |
|          | Digital level display                                 | ☑                |
| ±20%     | Maximum output power CUT (W)                          | 160 → 250Ω       |
| ± 20%    | Maximum output power BLEND (W)                        | 120 → 200Ω       |
| ± 20%    | Maximum output power COAG FORCED (W)                  | 100 → 150Ω       |
| ± 20%    | Maximum output power COAG SOFT (W)                    | 80 → 100Ω        |
| ± 20%    | Maximum output power BIPOLAR (W)                      | 60 → 100Ω        |
| ± 5%     | Modulation factor CUT                                 | Pure 100%        |
| ± 5%     | Modulation factor BLEND                               | Pure 100%        |
| ± 5%     | Modulation factor COAG FORCED                         | Mod. 60%         |
| ± 5%     | Modulation factor COAG SOFT                           | Mod. 90%         |
| ± 5%     | Modulation factor BIPOLAR                             | Pure 100%        |
| -0.1+0.2 | Crest Factor CUT                                      | 1.5              |
| ± 0.3    | Crest Factor BLEND                                    | 2.1              |
| ± 0.3    | Crest Factor COAG FORCED                              | 2.0              |
| ± 0.3    | Crest Factor COAG SOFT                                | 1.7              |
| -0.1+0.2 | Crest Factor BIPOLAR                                  | 1.5              |
| ± 10%    | Working frequency                                     | 600 kHz          |
| ± 15%    | Maximum output voltage CUT (Vpp on 5.2kΩ)             | 1050             |
| ± 15%    | Maximum output voltage BLEND (Vpp on 5.2kΩ)           | 1050             |
| ±15%     | Maximum output voltage FORCED (Vpp on 5.2kΩ)          | 1050             |
| ± 15%    | Maximum output voltage SOFT (Vpp on 5.2kΩ)            | 540              |
| ± 15%    | Maximum output voltage BIPOLAR (Vpp on 5.2kΩ)         | 540              |
| ± 0.5    | Weight Kg   | 5                |
| ± 10     | Size WxHxD mm   | 254x104x288      |
| ± 5%     | Selectable power (Vac)                                | 115-230          |
| ± 1%     | Mains frequency (Hz)                                  | 50-60            |
|          | Fuses (230Vac) 5x20 type TIMED                        | 2x T3.15AL, 250V |
|          | Fuses (115Vac) 5x20 type TIMED                        | 2x T6.3AL, 250V  |
| ± 10%    | Electrical input power (VA)                           | 350              |
| ± 10%    | Electrical input current (A) 230Vac                   | 1.5              |
| ± 10%    | Electrical input current (A) 115Vac                   | 3                |
| ± 5      | Five steps adjustable sound level (from 55- to 75dBA) | ☑                |
|          | Self-check  | ☑                |
|          | Power accuracy output warning                         | ☑                |
|          | Split or not split patient plate allowed              | ☑                |
|          | Last working condition storing                        | ☑                |
|          | Electrical Class (EN60601-1)                          | I CF             |
|          | MDD 93/42/ECClass                                     | II b             |
|          | EN55011 (CISPR 11) Class (Group/Class)                | 2 / B            |
|          | Patient circuit                                       | -F-              |
|          | Duty Cycle (action / pause) in seconds                | On 10 / Off 30   |
|          | Output power control by foot-switch or finger-switch  | ☑                |
|          | Defibrillation-proof                                  | ☑                |
|          | Equipotential binding                                 | ☑                |
|          | ABS cabinet   | ☑                |

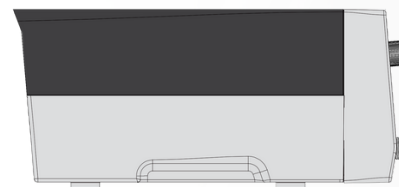

## Target Procedures

- Dermatology
- Gynecology
- Vascular Surgery
- Otorhinolaryngology
- Plastic Surgery
- Orthopedics
- Pediatric Surgery
- Trauma
- Gastroenterology
- Endoscopy



## Standard Accessories

- Reusable monopolar handle
- Assorted electrodes (10 pcs)
- Cable for rod neutral electrode
- Rod neutral electrode
- Foot switch
- Power supply cable 2 mt
- Electrodes and handle support

**INFINIUM**<sup>®</sup>

Infinium Medical  
12151 62nd St North #5  
Largo, FL 33773 • USA

☎ (1) 866-918-8434  
🌐 [infiniummedical.com](http://infiniummedical.com)  
✉ [sale@infiniummedical.com](mailto:sale@infiniummedical.com)